

xylem



Smart, sustainable water technologies
for high-performance data centres.

Powering the digital world with energy-efficient solutions.



Data Centre Challenges

Addressing your sustainability goals



Support for sustainability standards

Xylem's solutions help meet key sustainability standards like LEED and BREEAM, ensuring environmental compliance, such as:

- Minimising the use of rare earth magnets within our products
- Creating energy-efficient products to reduce water and energy use within buildings



Reducing PUE, WUE & CUE Impact

Technologies reduce water and energy consumption, lowering carbon footprints and enhancing environmental performance with:

- IE5 motor
- High efficiency variable frequency drive hydrovar® X helping to **reduce up to 40% pump consumption**



Certifications and Credentials

Provision of environmental certifications helps to comply with regulations and meet client expectations



Commitment to Sustainability

Xylem's product design, operations, and partnerships reflect strong dedication to sustainable, responsible development, including:

- Reduce our own water intensity by 30% by 2030
- Net zero by 2050, by decarbonising the water sector

Precision cooling for high-performance data centres.

Xylem's liquid cooling systems are engineered to help data centres meet and exceed Power Usage Effectiveness (PUE) targets, including those set by the EU Energy Efficiency Directive.

Our intelligent pumping and hydraulic systems deliver:

- Up to IE5 motor efficiency
- High-density liquid cooling
- Simplified commissioning and remote monitoring

With deep expertise in mission-critical cooling, we help you achieve:

- Lower operational costs
- Significant energy savings
- Reduced carbon footprint
- Enhanced system reliability
- Ensure you increase your **uptime**
- Improved uptime and scalability



Discover more at [xylem.com](https://www.xylem.com)

Power in partnership

From concept to commissioning and beyond, Xylem supports engineers and consultants at every stage of the data centre lifecycle. From planning to design, to commissioning, operation and ongoing scaling.

Xylem is your reliable solutions provider. Our solutions cover requirements for your tier 1 to tier 4 data centre requirements.

Plan | Design | Build | Operate | Scale



Integrated water distribution solutions

Our smart pump systems, including the Lowara hydrovar® X, are designed to optimise water flow and energy use across cooling and water reuse systems. These solutions support circular water management strategies, helping reduce water consumption and meet sustainability goals.

Applications include:

- Pumps for chiller and recirculation cooling systems
- Pumps for Coolant distribution units (CDUs)
- Treatment solutions for IEC
- HVAC solutions for the building
- Firefighting solutions
- Wastewater management
- Thermal and flow measurement
- Heat recovery solutions
- Server cooling solutions
- District heating

Empowering engineers and consultants to build a more water-secure, sustainable data centre...

As energy efficiency regulations tighten and data centre performance standards rise, the demand for intelligent, low-impact water systems is growing. By 2035, energy use from digital infrastructure is expected to double, with cooling systems playing a critical role in overall energy performance.

Source: Independent Commodity Intelligence Services (ICIS)

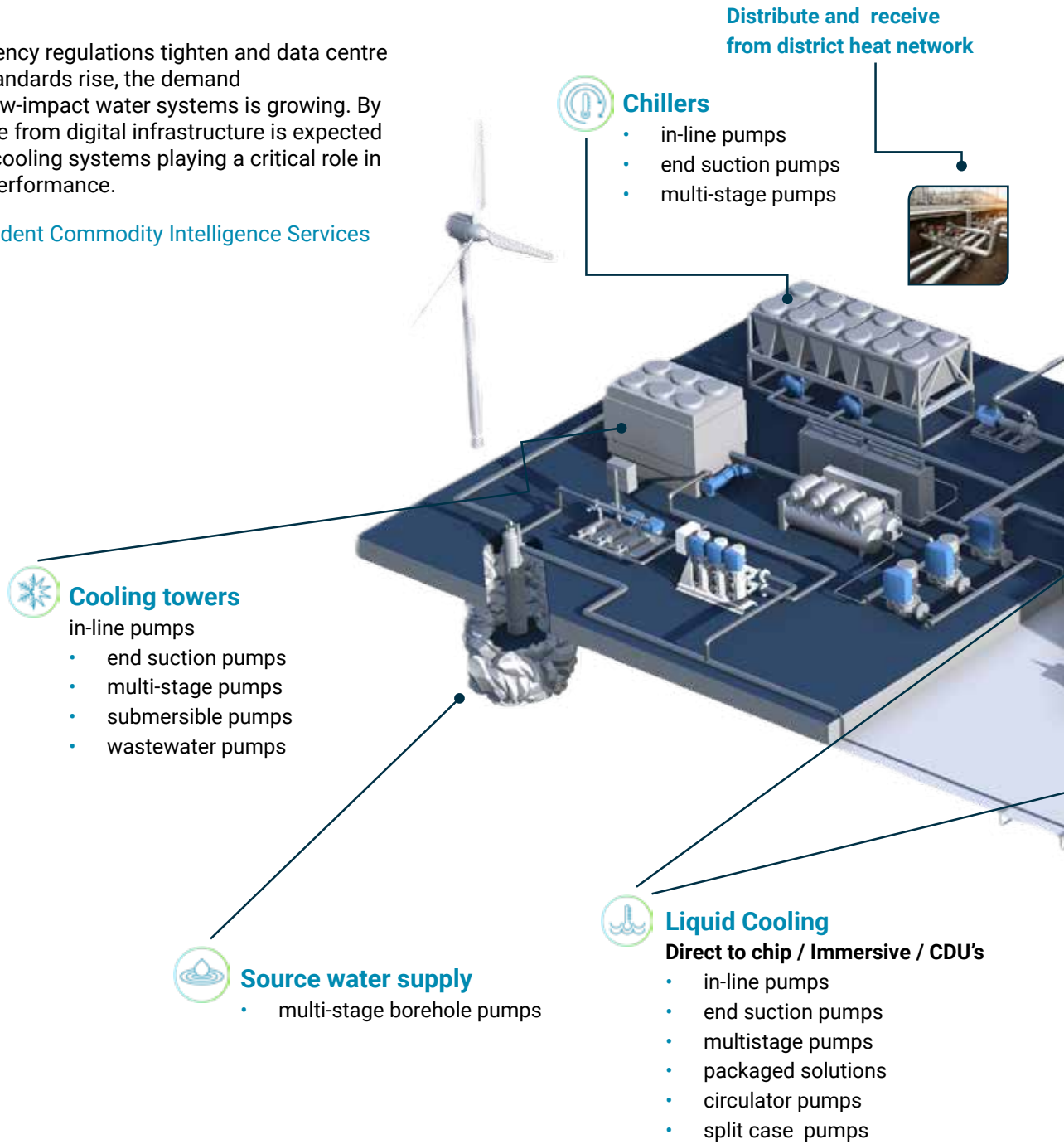

...that leads the way in environmental innovation and operational excellence

Rooftop free-cooling

- in-line pumps
- end suction pumps
- multistage pumps

Renewables

- in-line pumps
- end suction pumps
- multistage pumps
- packaged solutions

CRAH/CRAC unit

- circulator pumps
- in-line pumps

Firefighting

- packaged solutions

Dewatering & wastewater

- submersible pumps
- wastewater pumps

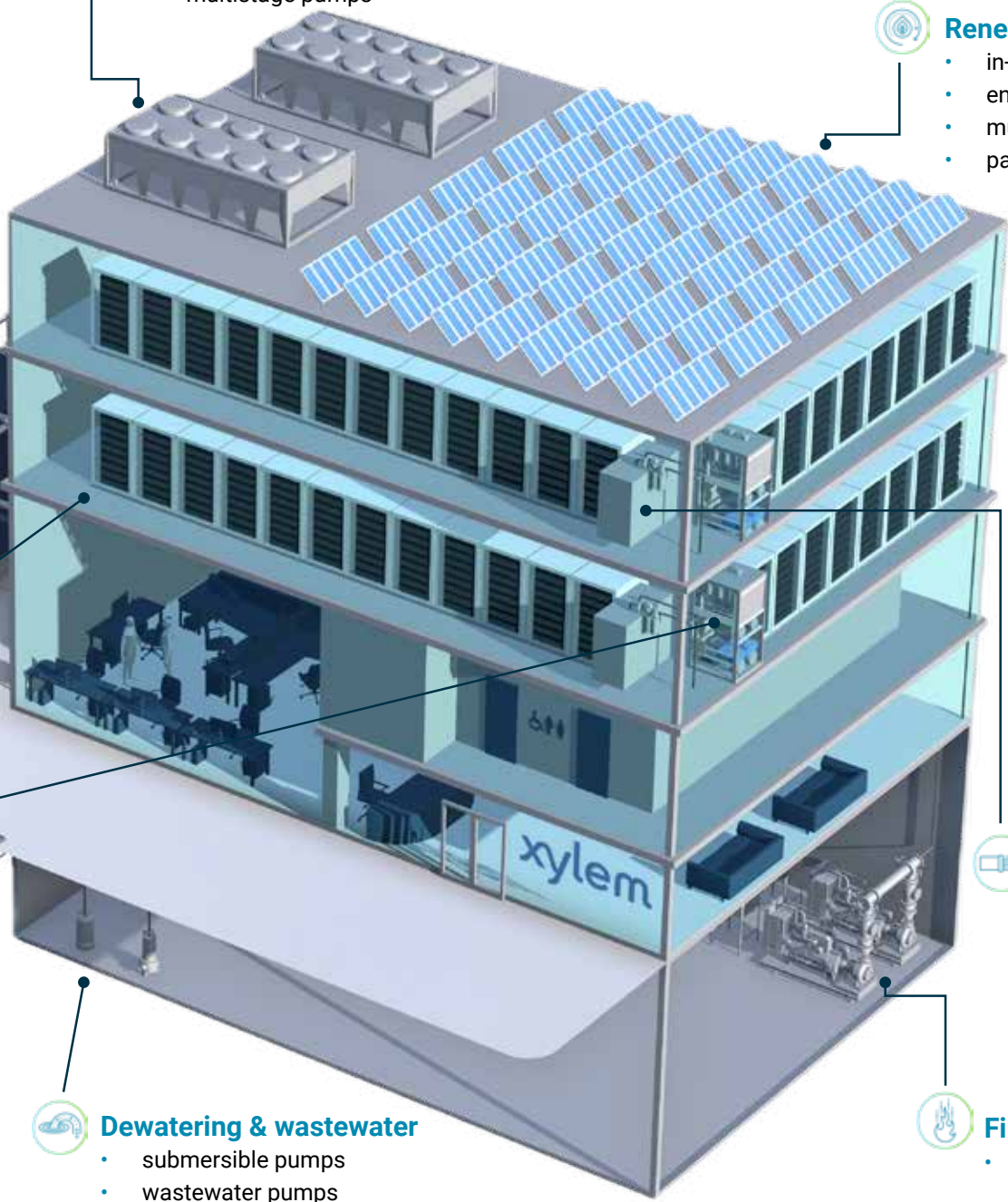

Single or double in-line pumps

The high efficiency approach, the hydraulic performance optimised for variable speed control and the compact footprint makes the e-LNE in-line pump the perfect choice for demanding HVAC and building services applications. The twin head e-LNT offers high redundancy and space saving thanks to being two pumps in one.

Product features:

- High efficiency hydraulics
- Compact footprint
- Options for IE5 motors
- Delivery up to 900m³/h
- Head up to 95m



Stainless steel end suction pumps with closed and open impeller

The Lowara end suction pump ranges combine high-efficiency with high flexibility regarding installation, material options and temperature. Optimised for very low running costs with IE3 or IE4 motors.

Product features:

- Stainless steel execution in A304 or A316
- Robust and reliable design
- Delivery up to 56m³/h
- Head up to 50m

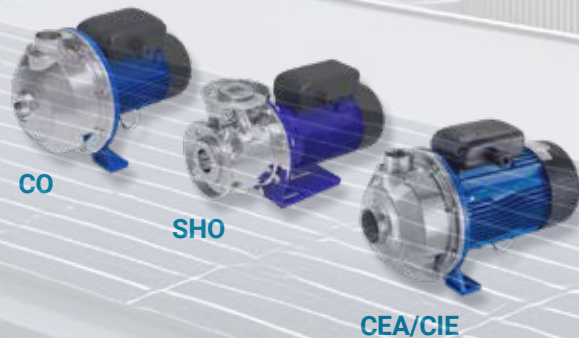

Multistage pumps

The Lowara e-SV is a highly reliable and technologically advanced multipurpose vertical multistage pump capable of satisfying the needs of a wide variety of users thanks to its multiple and different construction designs.

Product features:

- High efficiency hydraulics
- Compact footprint
- Options for IE5 motors
- Delivery up to 160m³/h
- Head up to 330m



Single-stage end-suction centrifugal pumps in A316 stainless steel

The Lowara e-SH series is a single impeller centrifugal pump made in AISI 316 stainless steel making it the right pump for moving water and aggressive liquids in a vast number of applications where high chemical resistance is needed.

Product features:

- High efficiency for energy saving
- Highly versatile owing to a wide selection of materials
- Delivery up to 240m³/h
- Head up to 160m



e-SH

Single-stage end suction centrifugal pumps

The Lowara e-NSC end-suction pumps combine high efficiency with high flexibility regarding installation, material options and temperature. This makes the e-NSC the natural choice for water transport, hydronic heating and chiller systems, fire protection systems and a vast number of industrial applications.

Product features:

- Robust design for reliability & reduced maintenance
- Highly versatile owing to a wide selection of materials
- Delivery up to 1900m³/h
- Head up to 160m



e-NSC

Single-stage end-suction industrial centrifugal pumps

e-IXP is the innovative Xylem Industrial Pump designed according to ISO 2858 and 5199 to be the solution to industrial applications. The e-IXP is a single stage volute casing end suction pump, available in different constructions thanks to a true modular design.

Product features:

- Reliable and efficient pump with reduced lifecycle cost
- Various shaft sealing configurations
- Delivery up to 1270m³/h
- Head up to 160m



e-IXP

Horizontal multistage pumps

The e-HM™ series are highly modular pumps fitted with an innovative hydraulic design. They secure energy savings through high efficiency performance, and high reliability thanks to the native balancing thrust and robust construction in stainless steel. Multiple technological features allow this pump to maintain constant performance over time.

Product features:

- Minimal leakage risk
- Tailor-made for a full range of applications
- Delivery up to 29m³/h
- Head up to 160m



e-HM



Submersible dewatering and wastewater pumps

With a comprehensive range and high-quality materials, Lowara guarantees optimum performance and long service life in all drainage applications. Whether it's for simple domestic pumping or the treatment of the most contaminated water, Lowara solutions are designed to meet every hydraulic challenge efficiently

Product features:

- Simple to install, operate and maintain
- Robust and reliable, even in extreme conditions
- Delivery up to 10.8m³/h
- Head up to 28m



Multistage borehole pumps

The 4" -12" submersible borehole pump range is available in AISI 304, AISI 316 and duplex stainless steel for long service life. The hydraulics are designed for high sand handling capability. The pumps are used in water supply, desalination and deep well dewatering applications.

Product features:

- Simple installation with customisable power supply cable & float switch
- High-efficiency hydraulics for optimised energy savings
- Delivery up to 700m³/h
- Head up to 78m



Scuba

Z6 6"

Split case and double suction pumps

Single stage double suction centrifugal pumps with extensive flow and head coverage and a common in-line configuration for easier installation of new and retrofit pumping systems. With 142 different size options, and hydraulics optimised by computational fluid dynamics calculations, the e-XC range allows you to select the most efficient pump for any duty point up to more than 11.000 m³/h – leading to significant savings both in new systems and when replacing existing pumps.

Product features:

- Wide range of sizes and variants to suit required water supply & pressure demand
- High efficiency for energy saving
- Suitable for medium and large capacity systems
- Delivery up to 11,400m³/h
- Head up to 220m

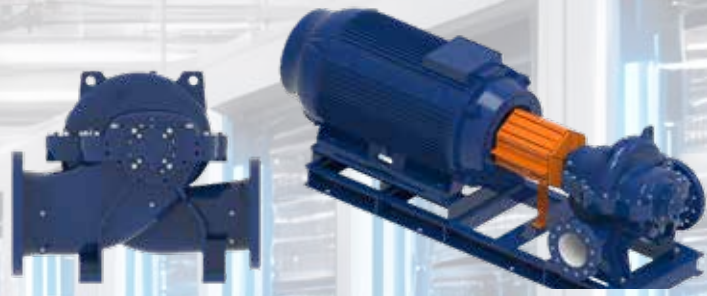

e-XC

Packaged solutions

The 4" -12" submersible borehole pump range is available in AISI 304, AISI 316 and duplex stainless steel for long service life. The hydraulics are designed for high sand handling capability. The pumps are used in water supply, desalination and deep well dewatering applications.

Product features:

- Extremely compact with different layout solutions, that fit even the most narrow spaces
- Adaptable to changing water supply demand thanks to multi-pump operation
- Fully assembled and tested for simple onsite plug-and-play installation
- Highly reduced water supply energy footprint
- High efficiency for energy and money saving. IE5 up to 22 kW
- Delivery up to 1280m³/h
- Head up to 160m



SMB with e-HME pumps



GHV with hydrovar X

Discover the hydrovar® X

When connectivity meets simplicity
and sustainability.



hydrovar® X, the answer to innovation, sustainability and user friendliness all-in-one.

hydrovar® X delivers the best in energy efficiency performances with its frequency converter coupled with the ultimate synchronous motor, manufactured by Xylem - integrating decades of expertise and know-how in pumping solutions.

It's the right combination of motors, variable speed drives and pumps that provide great performance, maximum savings and a rapid return on investment.



Unleash the power of
hydrovar® X at xylem.com

The ultimate integrated motor & drive solution in performance, energy efficiency, connectivity and simplicity

From cooling towers to direct-to-chip liquid cooling systems, Lowara hydrovar® X-enabled smart pump products are powerful enough to meet the demanding requirements of modern data center cooling.

Xylem's hydrovar® X represents a significant advancement in pump technology, integrating ultra-premium efficient motors with variable speed drives and pumps to deliver intelligence, performance, connectivity, and simplicity in a single package.

It is the right combination of motors, variable speed drives and pumps that guarantees optimum performance, maximum savings and a quick return on investment. In addition to being a variable speed drive, hydrovar® X is an intelligent control system that adapts precisely to the needs, helping end users obtaining cost and energy savings while achieving optimum performance.

Available in multi-configurations the hydrovar®X range allows you to harness it's power to keep your data centre running with minimal downtime, maximum flexibility and IE5 efficiency.

Rely on our integrated motor & variable speed drive solutions to cool the next generation of data center infrastructure for:

- Optimised energy consumption
- Enhanced system reliability
- Increased cost savings
- Better flexibility





Xylem Water Solutions UK
Millwey Industrial Estate, Axminster, EX13 5HU
Tel +44 (0) 1297 630200
xylem.com

All information presented herein is believed reliable and in accordance with accepted engineering practices. Xylem makes no warranties as to the completeness of this information. Users are responsible for evaluating individual product suitability for specific applications. Xylem assumes no liability whatsoever for any special, indirect or consequential damages arising from the sale, resale or misuse of its products. Subject to change without notice.

© 2025 Xylem Inc. or its affiliates. All rights reserved.

Data Centre Brochure - CBS

